

*Stancliffe Hall*

Corporate Events

A photograph of an open white door with gold trim, revealing a room with a floral armchair and glass display cabinets. The word "Welcome" is written in a white cursive font across the center of the image.

*Welcome*



Brian and I would like to take this opportunity to welcome you to Standcliffe Hall. Since first seeing our home in 2002 it has been our dream to share our 'beloved Standcliffe' with others.

Our journey has been a long one, the renovations sometimes painstaking, sometimes heartbreaking; but now at last we can look back and bask in its beauty. Standcliffe Hall is the most magnificent house set in beautiful parkland.

By drawing on our own business experiences we believe we have created the most unique environment for all types of corporate events.

Share the experience!

*Deborah & Brian*



A close-up photograph of a champagne bottle chilling in a silver bucket. The bottle's foil is gold and has 'CHAMPAGNE' printed vertically. A small white label on the neck features a red crest and the text 'ETIENNE DUMONT'. The bucket is highly reflective, showing distorted reflections of the bottle and the surrounding environment. The background is a soft-focus purple and red.

"Quite simply Stancliffe Hall is everything a venue should be and so much more".

# *Stancliffe Hall*

Nestled in over 50 acres of stunning parkland on the edge of the Peak District, Stancliffe Hall providing a truly unique and exclusive venue for corporate events and private parties of all kinds. Located in Darley Dale, Nr Matlock, this grade II listed hall is simply brimming with history, with some areas of the hall dating back to as far as the 15th century.

Enjoy a private, tranquil location with wonderful views of the Derbyshire countryside, you can be rest assured of total privacy whilst still being within close proximity to major cities such as Nottingham, Derby and Sheffield and Manchester.





# Corporate

## Discrete and Divine

Stancliffe Hall is the perfect venue for your event whether a small business meeting or a large conference. A great location for outdoor and country pursuits and boasts the ultimate backdrop for photo and film shoots.

Offering a range of flexible spaces to suit all requirements, all at ground floor level. Additionally the Hall also boasts luxurious facilities for relaxation and private dining.

As every event is individual to you, please contact us to discuss your requirements for 24 hour, day delegate rates, or tailored corporate packages.

T: 01629 736 956    E: [victoria@stancliffehall.co.uk](mailto:victoria@stancliffehall.co.uk)





*Magical  
Magnificent*



# Day Delegate Rates

## FULL DAY DAY DELEGATE RATE

8AM-6PM (TO INCLUDE SET UP)

Under 50 delegates (min number 20)	£55.00
50 - 100 delegates	£49.00

## HALF DAY DAY DELEGATE RATE

8AM-1PM OR 1PM - 6PM (TO INCLUDE SET UP)

Under 50 delegates (min number 20)	£35.00
50 - 100 delegates	£30.00

What's included in the day delegate rate?

- Exclusive use of the house and grounds
- Unlimited tea, coffee and biscuits
- Conference pad / pen
- Fresh fruit
- Bottled water
- Projector and screen
- Flip chart and pens
- Ample free parking for all delegates
- Free Wi-Fi
- Discounted accommodation for organiser

All packages are bespoke and can be tailored to your needs - please contact us for more details and pricing.

## VENUE HIRE RATES

The Whitworth Room	Half Day (4 hrs)	£450.00	Full Day (8 hrs)	£750.00
The 1816 room		£250.00		£550.00

# Catering

We can cater for all palettes - whether you are looking for an informal grazing style of dining, a hearty Derbyshire lunch or a beautifully prepared afternoon tea - all is possible. If staying overnight you can choose from either good old-fashioned home cooked food to a more fine dining 3 course dinner with matching flight wine for those who may wish to do so.

*The world really is your oyster when it comes to catering at Stancliffe Hall.*



## OVERNIGHT STAYS - WHAT TO EXPECT

- Check in from 4pm into one of nine charming bedrooms available
- Homemade tea and cake on arrival (why not upgrade to a glass of prosecco?)
- Have exclusive use of our billiards lounge and snug for those who wish to have a few quiet moments
- Approach the morning's meeting with a clear head after enjoying the use of our stunning spa facilities between 7am-10am
- Checkout of the bedrooms by 10am

£1,100 based on 5 rooms (double occupancy)

£2,200 based on 10 rooms (double occupancy)

For single occupancy reduce room rate by £15.00

All packages are bespoke and can be tailored to your needs - please contact us for more details and pricing.



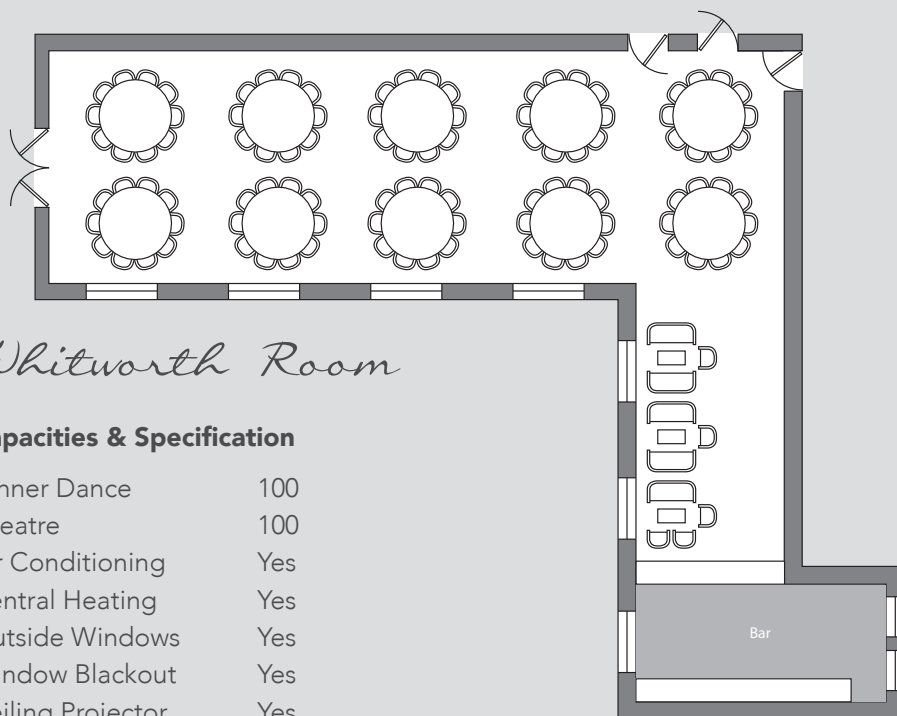

## Whitworth Room

### Capacities & Specification

Dinner Dance	100
Theatre	100
Air Conditioning	Yes
Central Heating	Yes
Outside Windows	Yes
Window Blackout	Yes
Ceiling Projector	Yes
Screen	Yes
Private Bar	Yes
Toilets	Yes

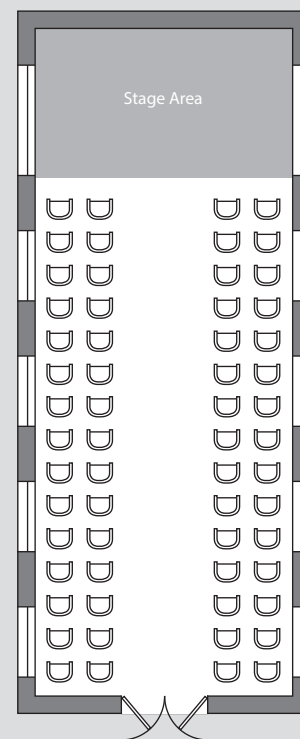

## 1816 Room

### Capacities & Specification

Dinner Dance	40
Theatre	70
Air Conditioning	No
Heating	Yes
Outside Windows	Yes







## Exclusive Events

Are you looking at celebrating a special occasion; be it a Birthday, a Christening, an Engagement party or you simply fancy a getaway to remember? Then look no further; Stancliffe Hall is the perfect venue for you. With our stunning home comes a promise to provide you and your guests with a 5 star service from the moment you arrive to the moment you leave.

### At Stancliffe our Exclusive Event Packages Include:

- Your own dedicated events planner
- A relaxing stay in one of our luxurious bedrooms or suites complete with robes and slippers (minimum of 5 rooms to be taken with 8 in total available).
- Full use of our stunning spa sanctuary; relax in our pool, jacuzzi or steam room or if you are feeling a little more energetic why not try our gym.
- Access to our billiards room and snug lounge
- The choice of 3 different dining rooms in which to hold your celebrations
- Your own bespoke menu carefully created alongside our in-house caterers Coghlan's
- 50 Acres of parkland in which to explore and spend time with your family and friends
- Free WiFi and ample free car parking

## Team Building, Outdoor and Country Pursuits

We also provide a wide variety of activities such as clay pigeon shoots, orienteering, croquet, paint balling or abseiling - all with local partners, many of which make the most of our 50 acres of stunning parkland.

## Photoshoot and Film Location

With its rich history, stunning setting and nature's own backdrop Stancliffe Hall is a dream location.

## The Ultimate Private Dining Experience

Host your own private dining event at Stancliffe Hall, from an executive dinner, business meeting or other special occasions. Stancliffe Hall will work with you to ensure a unique and truly unforgettable experience.

# *Homely History*







## Relaxation

While away the evening with an intimate dinner in our private dining room and fabulous cocktail bar followed by a game of billiards, or simply relax with a movie in the snug lounge.

Whatever your event - you'll find its perfect!





# Unwind

Your experience at Stancliffe can also include our stunning spa providing a sanctuary from the outside world. Relax in our pool, jacuzzi, steam room or if you're feeling a little more energetic try out our gym.

[www.stancliffehall.co.uk](http://www.stancliffehall.co.uk)







T: 01629 736 956 E: [victoria@stancliffehall.co.uk](mailto:victoria@stancliffehall.co.uk)



# *Stancliffe Hall*

STANCLIFFE HALL  
WHITWORTH ROAD  
DARLEY DALE  
MATLOCK  
DERBYSHIRE  
DE4 2HJ

TELEPHONE **01629 736 956**

EMAIL **[victoria@stancliffehall.co.uk](mailto:victoria@stancliffehall.co.uk)**  
**[www.stancliffehall.co.uk](http://www.stancliffehall.co.uk)**